

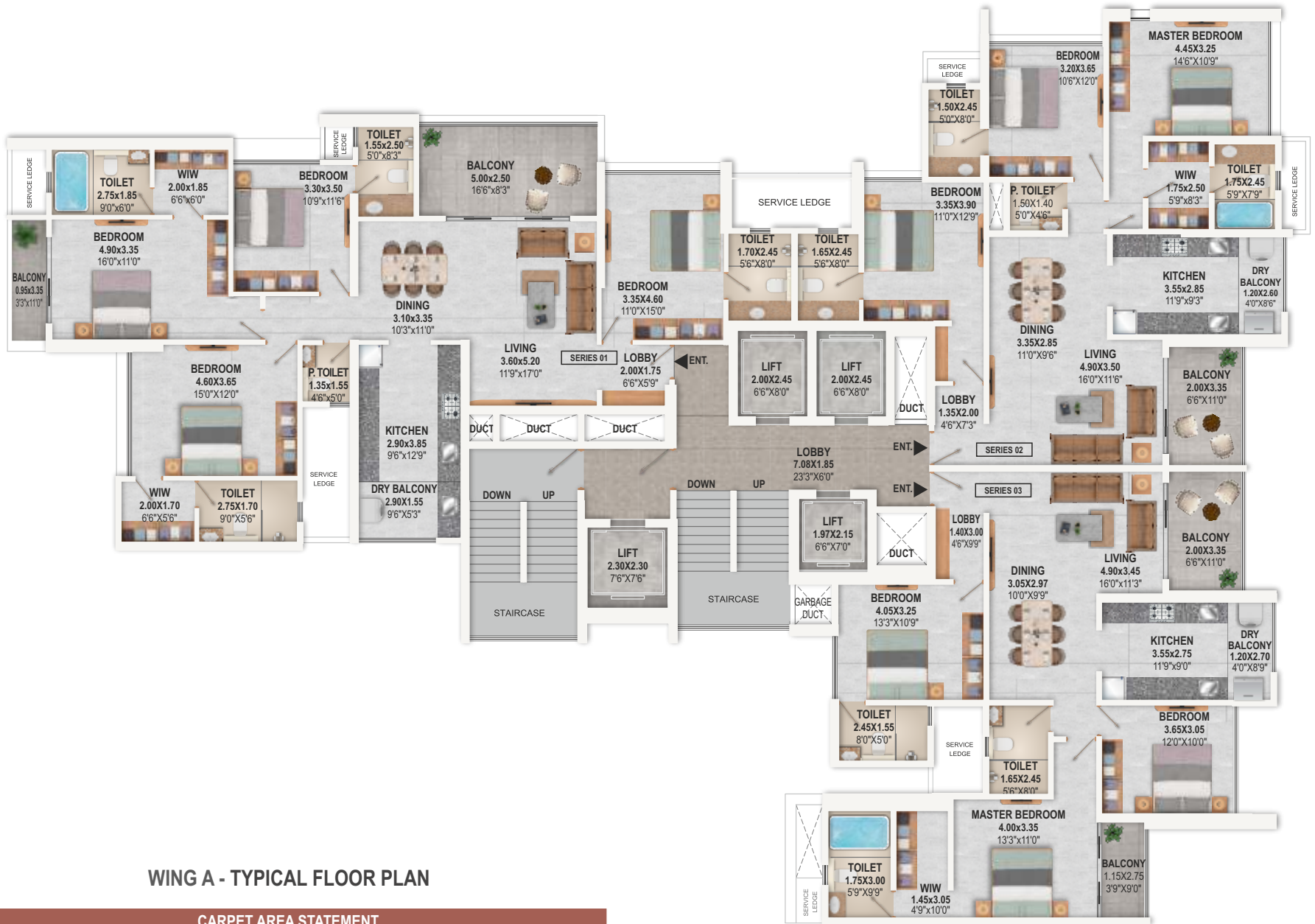

'A' WING FLOOR PLAN

4 & 3 BHK LUXEMENTS

BEHIND LIC OFFICE, CENTRAL SHIVAJINAGAR



**WING A - TYPICAL FLOOR PLAN**

**CARPET AREA STATEMENT**

FLAT NO.	FLAT TYPE	RERA CARPET (SQ.M.)	SITOUT	Encl. + Dry Balcony	P. Office	TOTAL (SQ.M.)	TOTAL (SQ.FT.)
<b>Series 1</b>	3 BHK + P. Office	119.67	16.18	4.50	24.84	165.19	1778
<b>Series 2</b>	2 BHK + P. Office	59.98	7.84	19.90	33.53	121.25	1305
<b>Series 3</b>	2 BHK + P. Office	59.85	11.66	10.25	36.86	118.62	1277



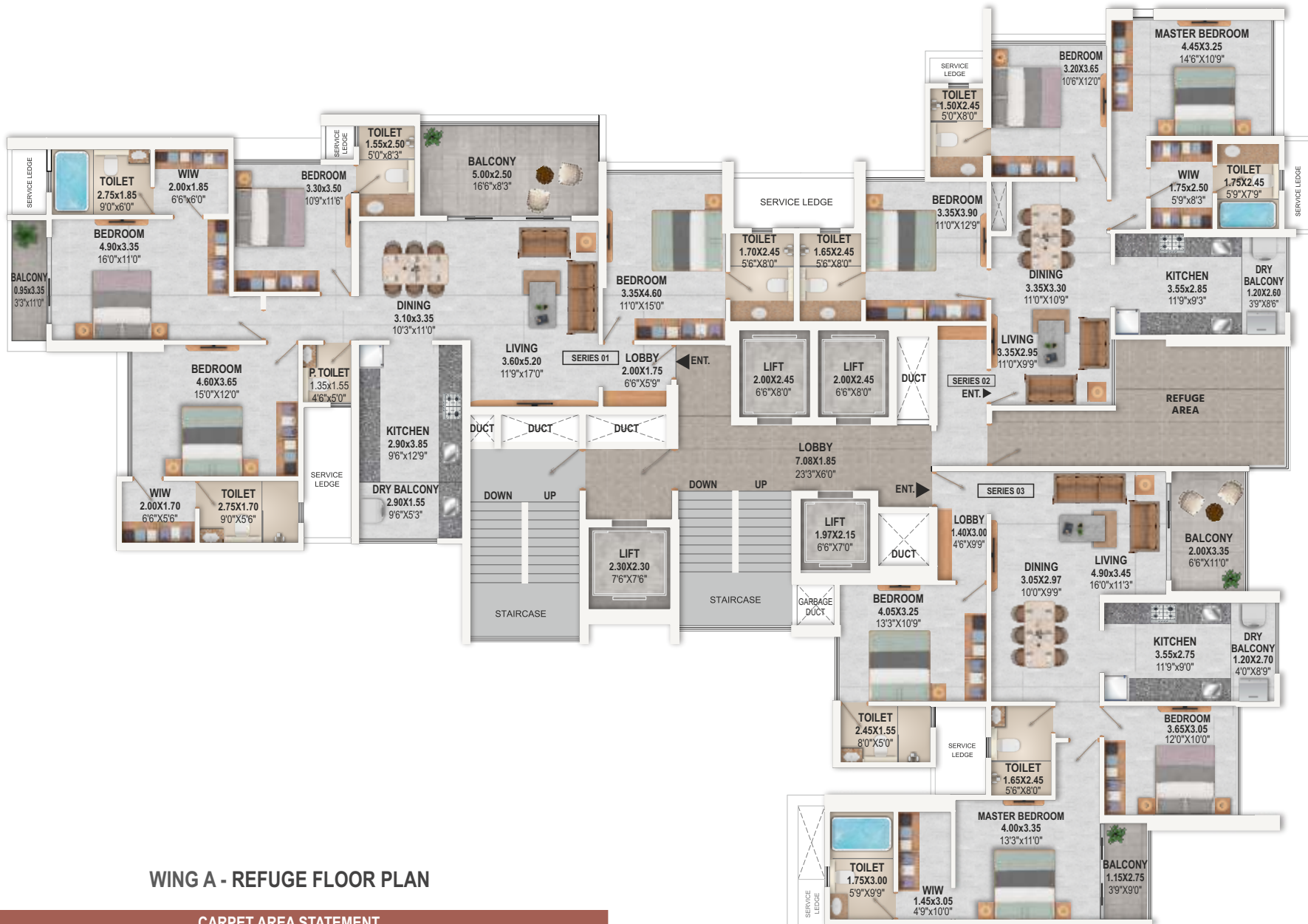

### WING A - REFUGE FLOOR PLAN

#### CARPET AREA STATEMENT

FLAT NO.	FLAT TYPE	RERA CARPET (SQ.M.)	SITOUT	Encl. + Dry Balcony	P. Office	TOTAL (SQ.M.)	TOTAL (SQ.FT.)
Series 1	3 BHK + P. Office	119.67	16.18	4.50	24.84	165.19	1778
Series 2	2 BHK + P. Office	49.89	0.00	19.68	26.44	95.01	1033
Series 3	2 BHK + P. Office	59.85	11.66	10.25	36.86	118.62	1277



A Project By:

**VENKATESH LUXE**  
BY ANKUSH ASABE

**Site Address:** Venkatesh Laurel, Plot No. 82 & 83, Behind LIC Divisional Office,  
Opp. ONP Hospital, Shivajinagar (Bhamburda), Pune - 411 005.

**Corporate Office:** Shree Venkatesh Buildcon Pvt. Ltd.  
7th Floor, Vikram Monarch, Ganeshkhind Road, Shivajinagar, Pune - 411016.

MEMBER:



**CREDAI**  
PUNE METRO



[www.venkateshbuildcon.com](http://www.venkateshbuildcon.com)

**Call:**

+91 70300 13377, +91 86055 11333



MahaRERA NO.: P52100055058  
<https://maharera.mahaonline.gov.in>

**Disclaimer:** This brochure is purely conceptual and not a legal offering nor will be part of the agreement. Images shown are for representation purpose only. Number of floors and number of units may be revised. Developer reserves the rights to amend the layout, plans, elevation, colour schemes, specifications, amenities, etc. without any prior notice.